

SALE

84 S HOMEWOOD PARK DR

84 S Homewood Park Dr Billings, MT 59106



SALE PRICE REDUCED TO \$690,000

Nathan Matelich, CCIM
(406)781-6889
nathan@cbcmontana.com

Michael Speidel
(406)601-9695
michael@cbcmontana.com

©2023 Coldwell Banker. All Rights Reserved. Coldwell Banker Commercial® and the Coldwell Banker Commercial logos are trademarks of Coldwell Banker Real Estate LLC. The Coldwell Banker® System is comprised of company owned offices which are owned by a subsidiary of Anywhere Advisors LLC and franchised offices which are independently owned and operated. The Coldwell Banker System fully supports the principles of the Equal Opportunity Act.



SALE

84 S HOMEWOOD PARK DR

84 S Homewood Park Dr Billings, MT 59106



Sale Price	\$690,000
------------	------------------

OFFERING SUMMARY

Building Size:	5,760 SF
Lot Size:	5.99 Acres
Price / SF:	\$104.17
Zoning:	Outside City Limits/ No Zoning

PROPERTY OVERVIEW

- *PRICE REDUCED to \$690,000
- *5,800 SF New Construction Warehouse on 5.99 Acres
- *2 Sets of Utilities & 2 Bathrooms
- *Buyer Can Easily Demise into 2 Separate Shops by Installing a Wall
- *Ability to Add 1 Large Office or 2 Smaller Offices
- *4 qty 14 ft Overhead Doors
- *Shop Heaters and LED Lights
- *5.99 Acres Has Been Professionally Leveled and Ready to Build On
- *Numerous Options for Adding More Buildings – Self Storage, Warehouse or Shops
- *Property is Completely Fenced
- *Tons of Yard Space for Semi or Heavy Equipment Storage

LOCATION OVERVIEW

84 S Homewood Park Dr is a new construction shop with tons of outdoor yard space for semis or heavy equipment. Probably the most exciting feature about this property is the 5.99 acres which has just been professionally leveled to create endless opportunities to build additional shops, man caves, she sheds, self storage or warehouses. If you need additional ideas for how this property can be built out, look no farther than the “Shop World” property just to the south of 84 S Homewood Park Dr.

Nathan Matelich, CCIM
(406)781-6889
nathan@cbcmontana.com

Michael Speidel
(406)601-9695
michael@cbcmontana.com



**COLDWELL BANKER
COMMERCIAL**
CBS

SALE

84 S HOMEWOOD PARK DR

84 S Homewood Park Dr Billings, MT 59106



Nathan Matelich, CCIM
(406)781-6889
nathan@cbcmontana.com

Michael Speidel
(406)601-9695
michael@cbcmontana.com



**COLDWELL BANKER
COMMERCIAL**
CBS

SALE

84 S HOMEWOOD PARK DR

84 S Homewood Park Dr Billings, MT 59106



Nathan Matelich, CCIM
(406)781-6889
nathan@cbcmontana.com

Michael Speidel
(406)601-9695
michael@cbcmontana.com



**COLDWELL BANKER
COMMERCIAL**
CBS

SALE

84 S HOMEWOOD PARK DR

84 S Homewood Park Dr Billings, MT 59106

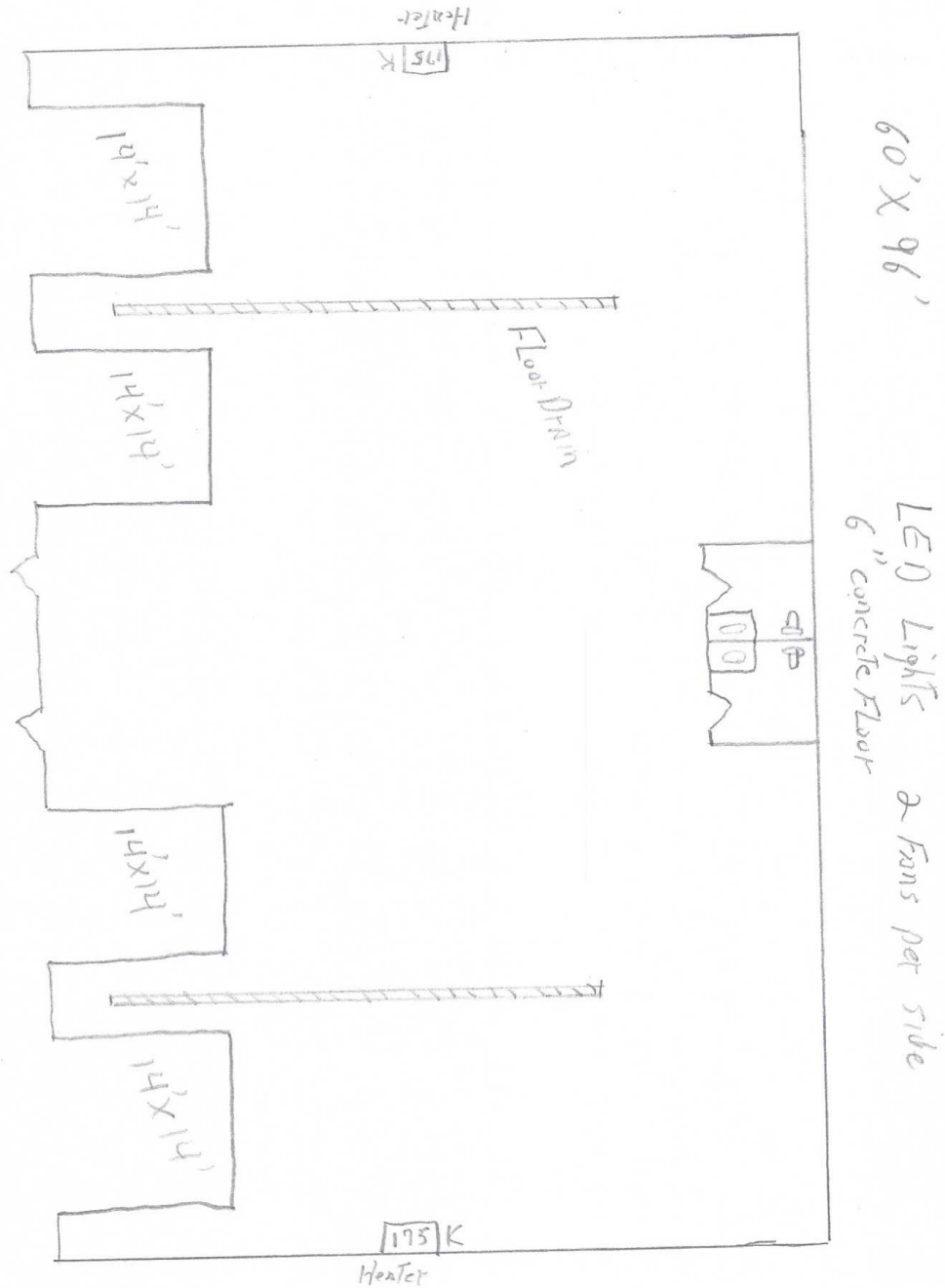

Nathan Matelich, CCIM
(406)781-6889
nathan@cbcmontana.com

Michael Speidel
(406)601-9695
michael@cbcmontana.com



**COLDWELL BANKER
COMMERCIAL**
CBS

SALE

84 S HOMEWOOD PARK DR

84 S Homewood Park Dr Billings, MT 59106



Nathan Matelich, CCIM
(406)781-6889
nathan@cbcmontana.com

Michael Speidel
(406)601-9695
michael@cbcmontana.com



**COLDWELL BANKER
COMMERCIAL**
CBS