



**COLDWELL
BANKER
COMMERCIAL**

CBS

FOR LEASE

2048 OVERLAND AVE, SUITE 101

2048 Overland Ave, Suite 101
Billings, MT 59102

AVAILABLE SPACE
3,514 SF

LEASE RATE
\$4,100.00 per month (utilities included)

AREA
2048 Overland is a professional office building conveniently located on the west end of Billings with easy highway access. Office building is moments away from Costco, shops and restaurants. Set up perfectly for any small business owner that needs a professional setting such a CPA, Lawyer, Financial Adviser, Engineer, Architect or other professional services firm.



OFFICE

Nathan Matelich
406 656 2001
nathan@cbcmontana.com

Todd Sherman
406 656 2001
todd@cbcmontana.com

CBCMONTANA.COM

©2021 Coldwell Banker. All Rights Reserved. Coldwell Banker and the Coldwell Banker Commercial logos are trademarks of Coldwell Banker Real Estate LLC. The Coldwell Banker® System is comprised of company owned offices which are owned by a subsidiary of Realogy Brokerage Group LLC and franchised offices which are independently owned and operated. The Coldwell Banker System fully supports the principles of the Equal Opportunity Act.



COLDWELL BANKER COMMERCIAL
CBS

1215 24th Street, Suite 240, Billings, MT 59102
406.656.2001



2048 OVERLAND AVE, SUITE 101

2048 Overland Ave, Suite 101, Billings, MT 59102



OFFERING SUMMARY

Available SF: 3,514 SF

Lease Rate: \$4,100 per month (utilities included)

Lot Size: 0.67 Acres

Year Built: 1984

Building Size: 12,426 SF

Zoning: CMU2-Corridor Mixed Use 2

CBCMONTANA.COM

Nathan Matelich
406 656 2001
nathan@cbcmontana.com

Todd Sherman
406 656 2001
todd@cbcmontana.com

PROPERTY OVERVIEW

*3,514 SF Office Suite for Lease

*\$4,100/mo (utilities included)

*Large Reception

*Copy room

*Storage room

*Conference room

*10 large offices

*2 doors to outside / private entrances

*Ground floor



COLDWELL
BANKER
COMMERCIAL

CBS



2048 OVERLAND AVE, SUITE 101

2048 Overland Ave, Suite 101, Billings, MT 59102

LEASE



CBCMONTANA.COM

Nathan Matelich
406 656 2001
nathan@cbcmontana.com

Todd Sherman
406 656 2001
todd@cbcmontana.com



CBS



2048 OVERLAND AVE, SUITE 101

2048 Overland Ave, Suite 101, Billings, MT 59102

LEASE



CBCMONTANA.COM

Nathan Matelich
406 656 2001
nathan@cbcmontana.com

Todd Sherman
406 656 2001
todd@cbcmontana.com



CBS



2048 OVERLAND AVE, SUITE 101

2048 Overland Ave, Suite 101, Billings, MT 59102

LEASE



CBCMONTANA.COM

Nathan Matelich
406 656 2001
nathan@cbcmontana.com

Todd Sherman
406 656 2001
todd@cbcmontana.com



**COLDWELL
BANKER
COMMERCIAL**

CBS



2048 OVERLAND AVE, SUITE 101

2048 Overland Ave, Suite 101, Billings, MT 59102

LEASE

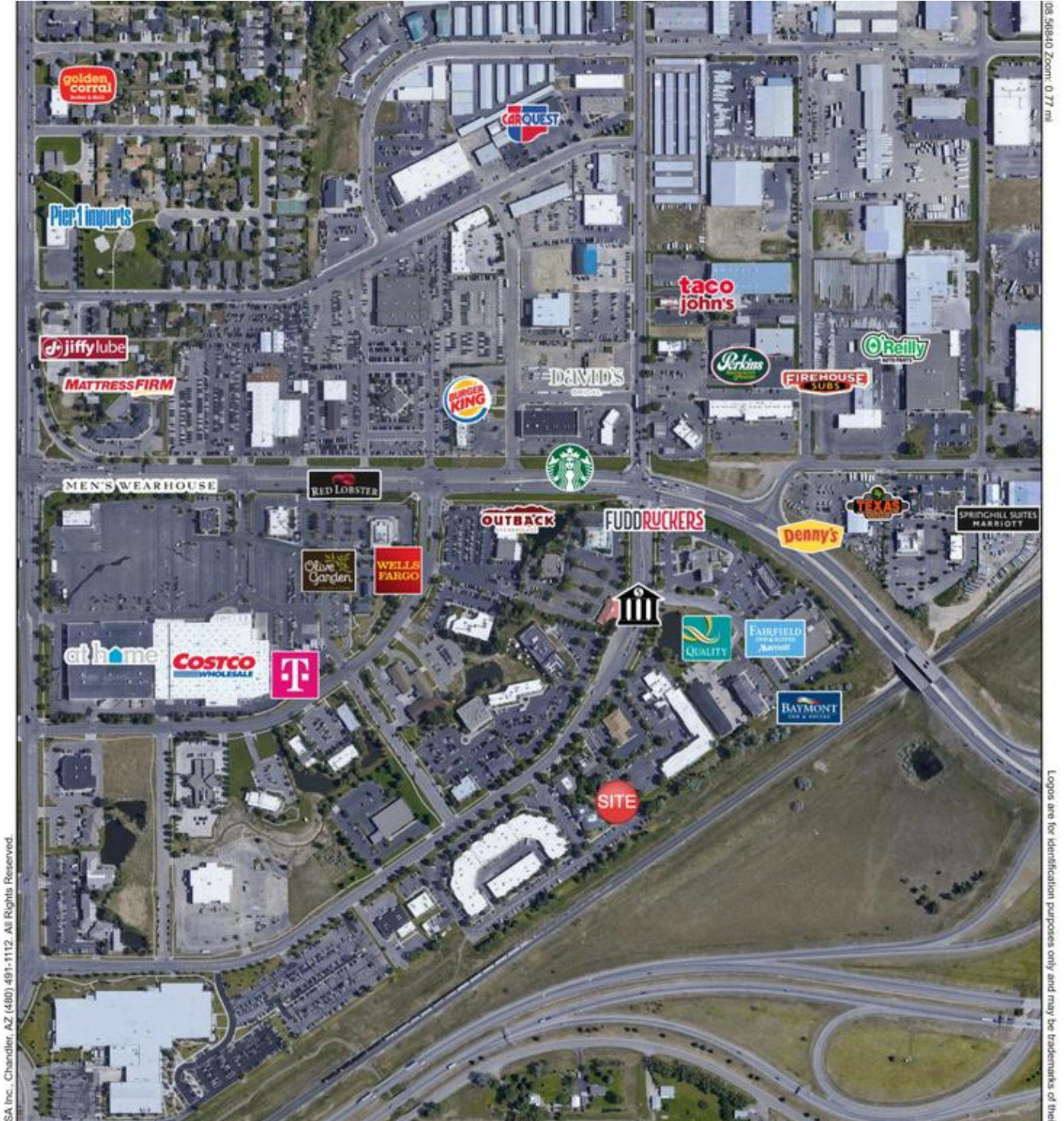

CBCMONTANA.COM

Nathan Matelich
 406 656 2001
 nathan@cbcmontana.com

Todd Sherman
 406 656 2001
 todd@cbcmontana.com



CBS



2048 OVERLAND AVE, SUITE 101

2048 Overland Ave, Suite 101, Billings, MT 59102

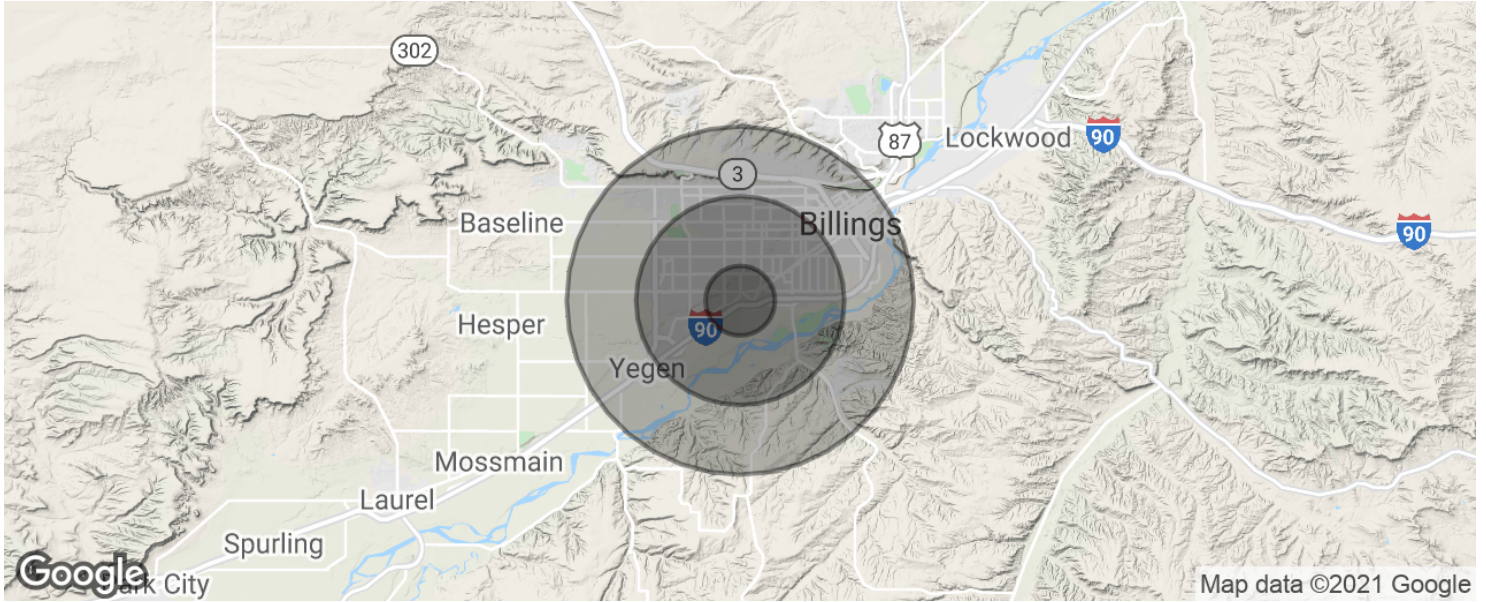

POPULATION	1 MILE	3 MILES	5 MILES
Total population	3,810	44,741	98,999
Median age	39.1	37.2	38.1
Median age (Male)	37.3	35.1	36.3
Median age (Female)	41.5	39.2	40.2
HOUSEHOLDS & INCOME	1 MILE	3 MILES	5 MILES
Total households	1,589	20,324	43,613
# of persons per HH	2.4	2.2	2.3
Average HH income	\$55,469	\$53,695	\$57,000
Average house value	\$154,569	\$160,627	\$186,286

* Demographic data derived from 2010 US Census

CBCMONTANA.COM

Nathan Matelich
 406 656 2001
 nathan@cbcmontana.com

Todd Sherman
 406 656 2001
 todd@cbcmontana.com



CBS