



**COLDWELL
BANKER
COMMERCIAL**

CBS

710 MAIN ST



708 MAIN ST

\$21.50 SF/yr (NNN)

708 Main St
Billings, MT 59105

AVAILABLE SPACE
1,140 SF

FEATURES

- Adjacent to City Brew and Brewer Dental
- High Visibility Corner
- ADA Restrooms
- High Traffic Count Location

AREA

Attractive retail space in the Billings Heights on Main St and Hansen Lane. High visibility corner adjacent to City Brew & Brewer Dental.

710 MAIN ST



FOR LEASE

CBCWORLDWIDE.COM

OFFICE

George Warner
406.855.8946
george@cbcmontana.com

Blaine Poppler
406.671.0399
blaine@cbcmontana.com

©2019 Coldwell Banker Real Estate LLC, dba Coldwell Banker Commercial CBS. All rights reserved. Coldwell Banker Commercial® and the Coldwell Banker Commercial logo are registered service marks owned by Coldwell Banker Real Estate LLC. Coldwell Banker Real Estate LLC, dba Coldwell Banker Commercial Affiliates fully supports the principles of the Fair Housing Act and the Equal Opportunity Act. Each office is independently owned and operated. The information provided is deemed reliable, but it is not guaranteed to be accurate or complete, and it should not be relied upon as such. This information should be independently verified before any person enters into a transaction based upon it.

**COLDWELL BANKER COMMERCIAL
CBS**
1215 24th Street, Suite 240, Billings, MT 59102
406.656.2001



708 MAIN ST

708 Main St, Billings, MT 59105

LEASE



OFFERING SUMMARY

Available SF: 1,140 SF

Lease Rate: \$21.50 SF/yr (NNN)

Lot Size: 0 Acres

Building Size: 1,140 SF

CBCWORLDWIDE.COM

George Warmer
406.855.8946
george@cbcmontana.com

Blaine Poppler
406.671.0399
blaine@cbcmontana.com

PROPERTY OVERVIEW

Attractive retail space available on Main St and Hansen Ln.

1,140 SF space

Lease Rate \$21.50 PSF NNN

PROPERTY HIGHLIGHTS

- Adjacent to City Brew and Brewer Dental
- High Visibility Corner
- ADA Restrooms
- High Traffic Count Location



**COLDWELL
BANKER
COMMERCIAL**

CBS



708 MAIN ST

708 Main St, Billings, MT 59105

LEASE

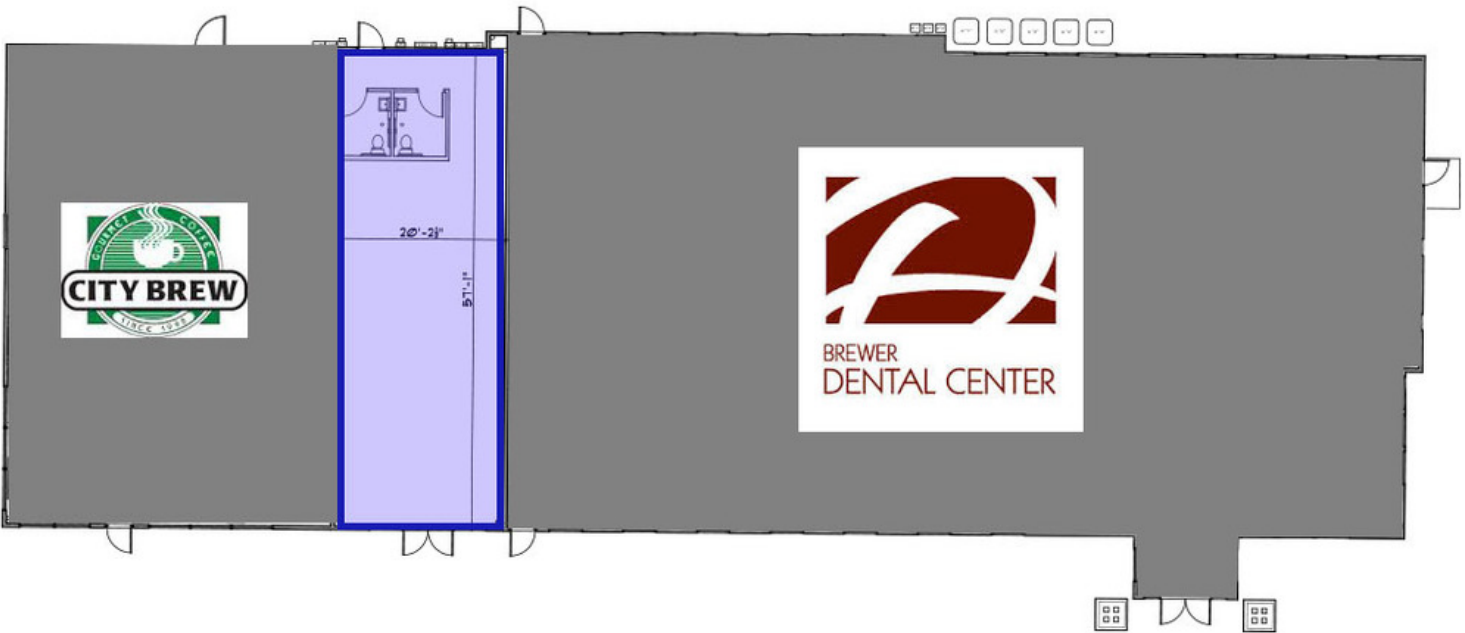

CBCWORLDWIDE.COM

George Warmer
406.855.8946
george@cbcmontana.com

Blaine Poppler
406.671.0399
blaine@cbcmontana.com



**COLDWELL
BANKER
COMMERCIAL**
CBS



708 MAIN ST

708 Main St, Billings, MT 59105

LEASE



CBCWORLDWIDE.COM

George Warmer
406.855.8946
george@cbcmontana.com

Blaine Poppler
406.671.0399
blaine@cbcmontana.com



COLDWELL
BANKER
COMMERCIAL

CBS



708 MAIN ST

708 Main St, Billings, MT 59105

LEASE

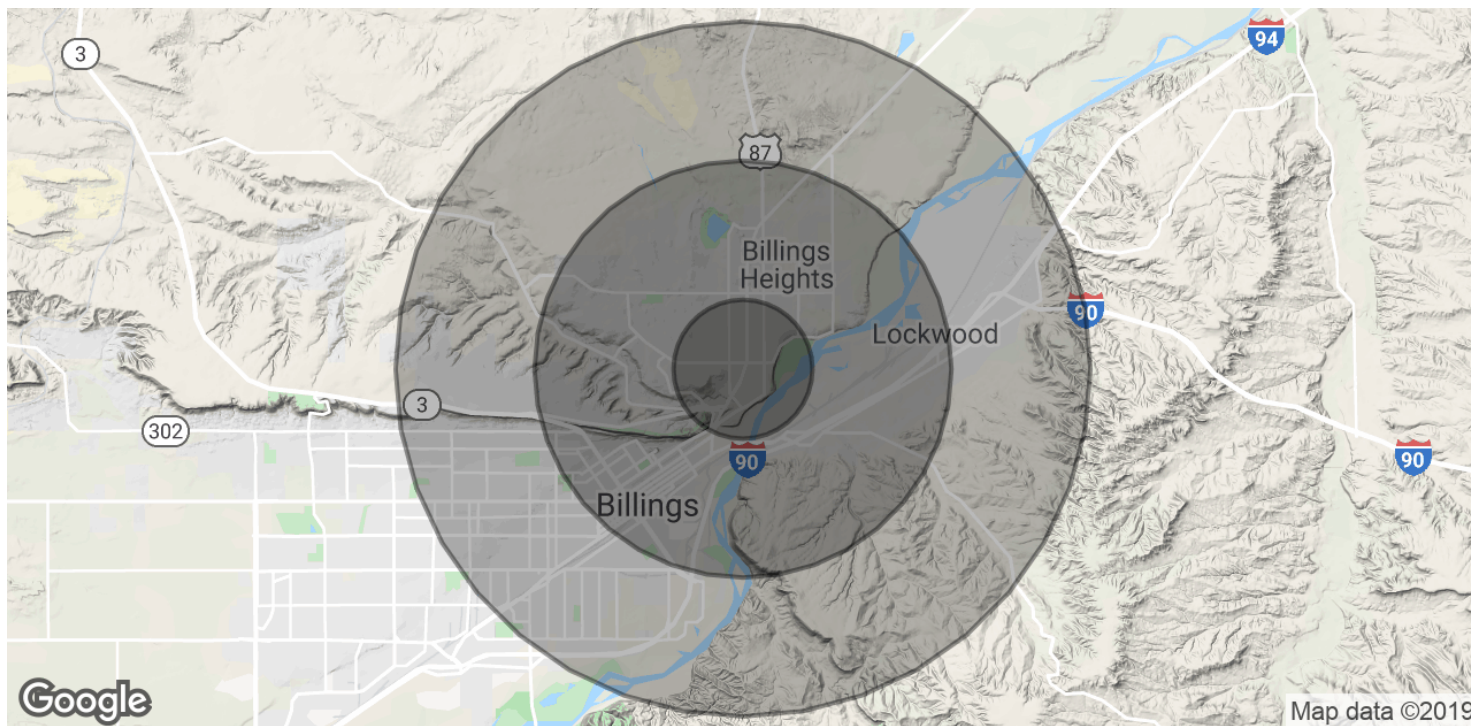

POPULATION	1 MILE	3 MILES	5 MILES
Total Population	6,346	39,050	74,500
Median age	38.1	36.0	35.2
Median age (Male)	35.7	34.3	33.9
Median age (Female)	39.0	37.4	37.1

HOUSEHOLDS & INCOME	1 MILE	3 MILES	5 MILES
Total households	2,905	15,979	30,677
# of persons per HH	2.2	2.4	2.4
Average HH income	\$44,239	\$55,251	\$52,839
Average house value	\$159,815	\$149,797	\$152,693

* Demographic data derived from 2010 US Census

CBCWORLDWIDE.COM

George Warmer
406.855.8946
george@cbcmontana.com

Blaine Poppler
406.671.0399
blaine@cbcmontana.com



**COLDWELL
BANKER
COMMERCIAL**

CBS